

*Save time and money go directly to
the best and quickest agent*

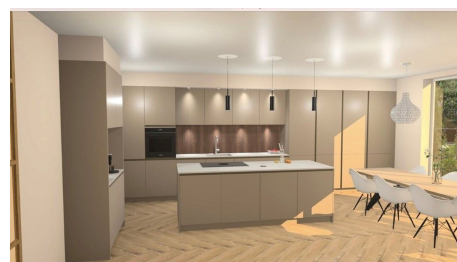

Noorddammerlaan, Amstelveen

Please note that the house is currently under construction and is expected to finish beginning of June 2026.

This semi-detached house offers traditional Dutch charm and a high-end infrastructure. The house is located in one of the most expat family-oriented pockets of Amstelveen, providing a safe, "village-style" environment where children can play freely, yet parents remain minutes away from the

Type	: Duplex
Decoration	: Semi Furnished
Garden	: Yes, Backyard, 100×100cm
Living Surface	: 280m ²
Rooms	: 6

Rent € 7.000 p.m. excl. per month